

"Traditional Rib" Series 306 Standing Seam Panel

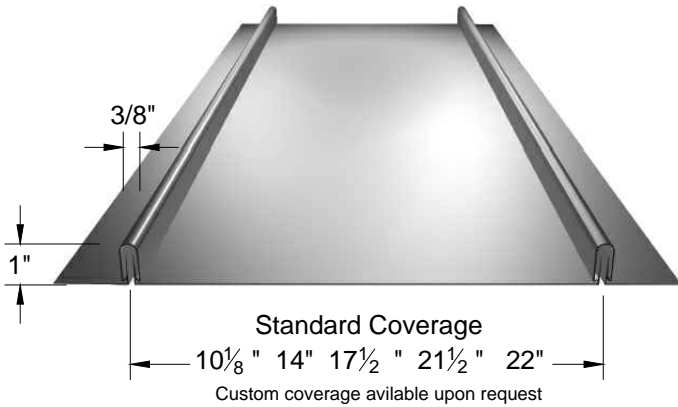

Applications

Architectural roofing on slopes 3" or greater. Continuous lengths up to 45 ft. Vertical walls, conical tapers and radius barrels.

Substrates

Solid deck plywood or rigid insulation over decking. Requires minimum 30# felt underlayment and rosin slip sheet.

Materials

Aluminum (3000 series alloy)
 Galvanized coated steel (G-90)
 Alum-Zinc coated steel (AZ-50 & AZ-55)
 Copper & lead coated Copper
 Also available in Zinc & Pre-Weathered Zinc

Standard Gauges

| | |
|--------|--------|
| .032" | .040" |
| 24 ga. | 22 ga. |
| 24 ga. | 22 ga. |
| 16 oz. | 20 oz. |

Finishes

Kynar & Metallic Fluoropolymer Coatings
 Mill Finish, Brushed, Anodized
 Texture: Smooth or Stucco Embossed

Manufacturing

Factory Formed
 Factory & Field Curved

Testing / Agency Approvals

UL-90 Uplift ASTM E-331 ASTM E-283

Some panels configurations are not suitable for all applications. Contact sales & engineering for more information.

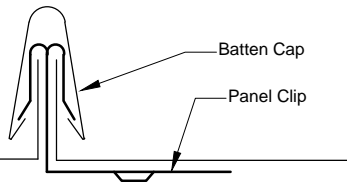

Panel Side Joint

Traditional narrow seam snap on batten. Available in a variety of coverages. Alternative seam height available.

Components

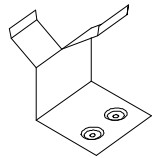

#306 Clip

One piece 24 gauge galvanized steel clip. Allows for free movement of panels during thermal expansion and contraction. Also available in Stainless Steel.

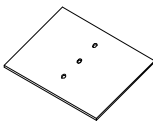

Punched Bearing Plate

6" x 6" 22 ga. galvanized. For clip support over rigid insulation.

Seam Trim

Rib knee transition. Supplied in 10'-0" lengths.



S-5-U & S-5-U Mini Clamp

Aluminum block for use with S-5! snow retention system and for other practical purposes.

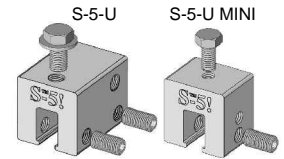

S-5! ColorGard Snow Retention System

Refer to PS-12 for more information.

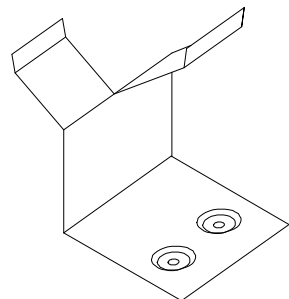
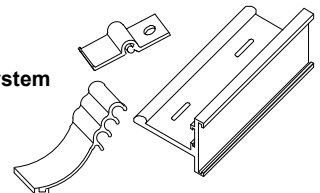

Before Closing

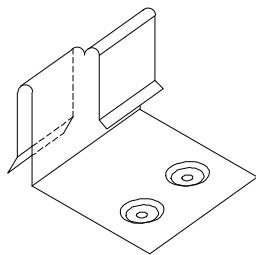

After Closing

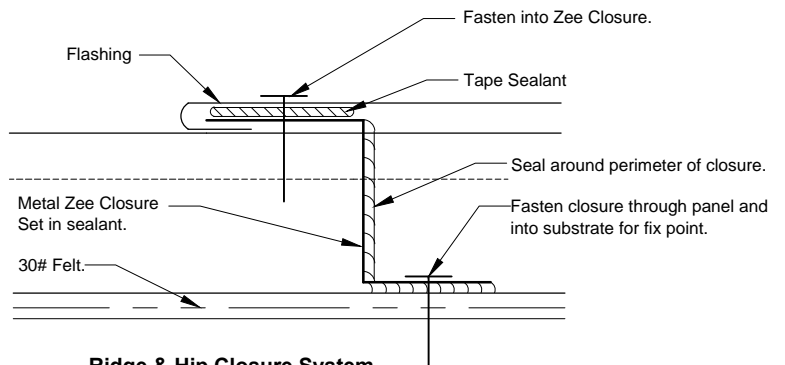

Ridge & Hip Closure System

10' metal Zee closure. Cut to suit between panel ribs.

Updated December 2011

Merchant & Evans, Inc.
 308 Connecticut Drive
 Burlington, NJ 08016

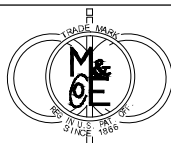

Phone: 800-257-6215
 Phone: 609-387-3033
 Fax: 609-387-4838
 www.ziprib.com